

1331 MAPLE STREET:
 Farmington, MO 63640

FOR LEASE:
 Elizabeth Short, eshort@paceproperties.com
 314-968-9898



1331 MAPLE OFFERS:

- Visibility from Highway 67
- Parking ration 5 per 1,000 SF
- New construction

AREA TENANTS INCLUDE:

Pro Rehab, Payday Loans, Sun Loan, Colton's Steakhouse & McCormicks

TRAFFIC COUNTS:

Highway 67: 13,494 VPD
 Maple Valley @ Maple Street: 11,149 VPD

SQUARE FEET AVAILABLE:

1,200-2,400 SF

LEASE RATE:

\$13.00/sf

TRIPLE NETS:

\$2.75, NNN

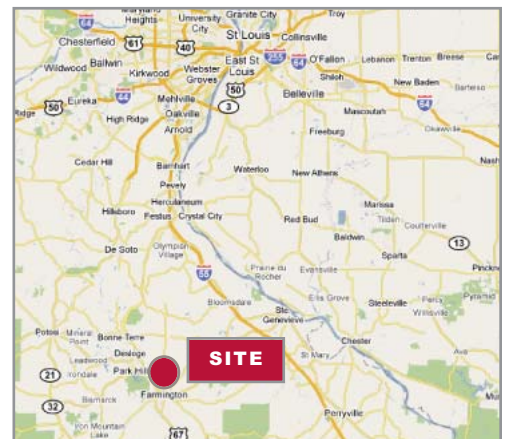

FARMINGTON, MO

DEMOGRAPHICS <small>(2000 Census, 2009 Estimates)</small>	5-MILE	10-MILE	15-MILE
Population	24,567	50,187	70,094
Average HH Income	\$48,084	\$47,388	\$46,866
No. of Employees	13,638	22,789	26,672

The information contained herein is not warranted, although it has been obtained from the owner/landlord of the subject property or from other sources that Pace Properties, Inc. deems reliable, and is subject to change without notice. Owner/landlord and Pace Properties, Inc. make no representations as to the environmental condition of the subject property and recommend tenant's independent investigation.

PACE

PROPERTIES

Pace Properties

1401 South Brentwood Boulevard
Suite 900 - St. Louis, Missouri 63144
Phone: 314.968.9898
Fax: 314.968.5050
www.paceproperties.com

SITE PLAN:

FOR LEASE:

Elizabeth Short, eshort@paceproperties.com
314-968-9898

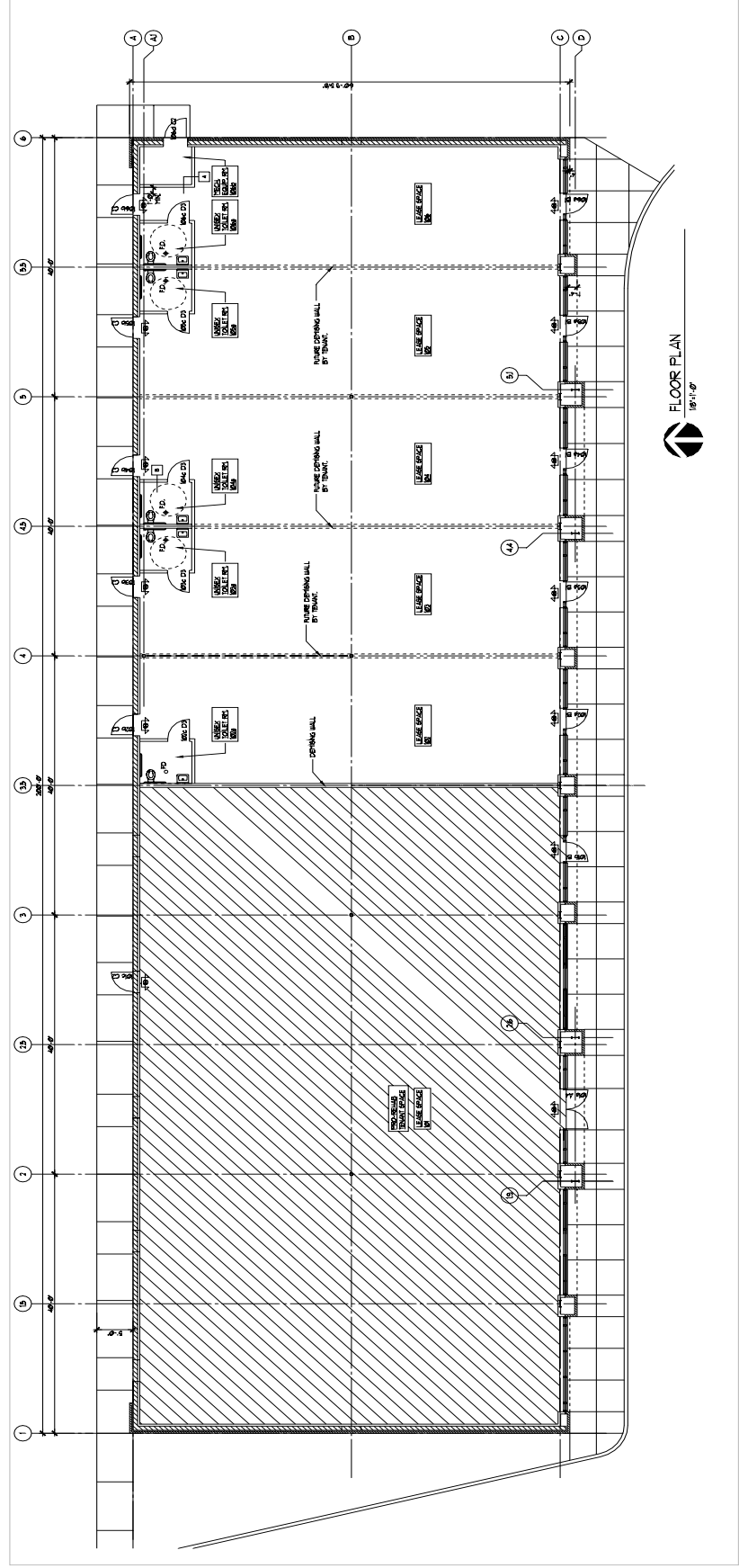

FLOOR PLAN
1/8"=1'-0"