

FOR LEASE

# LEMAY FERRY SHOPPING CENTER

1032 Lemay Ferry Road | St. Louis, Missouri 63125

# PACE

PROPERTIES



**SPACE AVAILABLE:** 1,000 - 2,500 SF  
**LEASE RATE:** \$18/SF, NNN  
**TRIPLE NETS:** \$4.61 (2018 ESTIMATE)

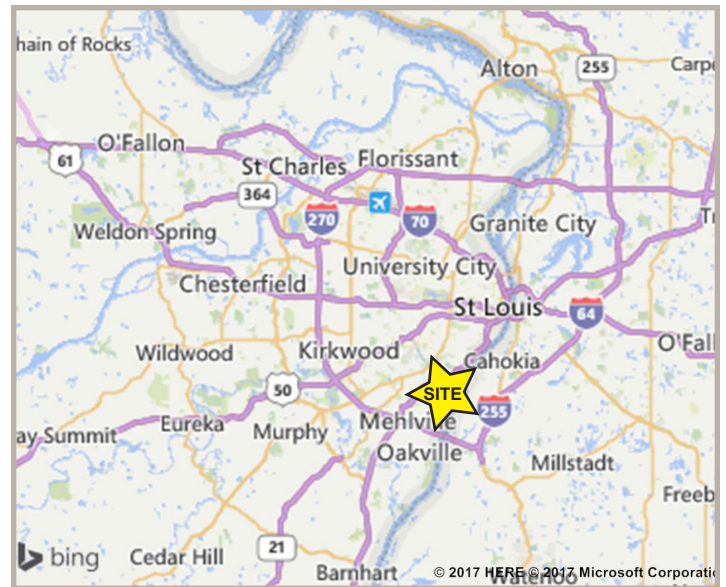

2018 DEMOGRAPHICS		1 MILE	3 MILE	5 MILE	
	POPULATION		12,550	87,600	247,760
	EMPLOYEES		3,265	23,935	79,592
	MEDIAN HH INCOME		\$52,844	\$55,016	\$55,991

## CONTACT US FOR MORE INFORMATION

**Joe Ciapciak**  
 JCiapciak@paceproperties.com  
 314.785.7700

**Lauren Berry**  
 LBerry@paceproperties.com  
 314.785.7632

## PACEPROPERTIES.COM

1401 South Brentwood Blvd., Suite 900  
 St. Louis, Missouri 63144  
 P: 314.968.9898

A MEMBER OF  
**CHAINLINKS**  
 RETAIL ADVISORS

The information contained herein is not warranted, although it has been obtained from the owner/landlord of the subject property or from other sources that Pace Properties, Inc. deems reliable, and is subject to change without notice. Owner/landlord and Pace Properties, Inc. make no representations as to the environmental condition of the subject property and recommend tenant's independent investigation.

**FOR LEASE**  
**LEMAY FERRY SHOPPING CENTER**  
 1032 Lemay Ferry Road | St. Louis, Missouri 63125

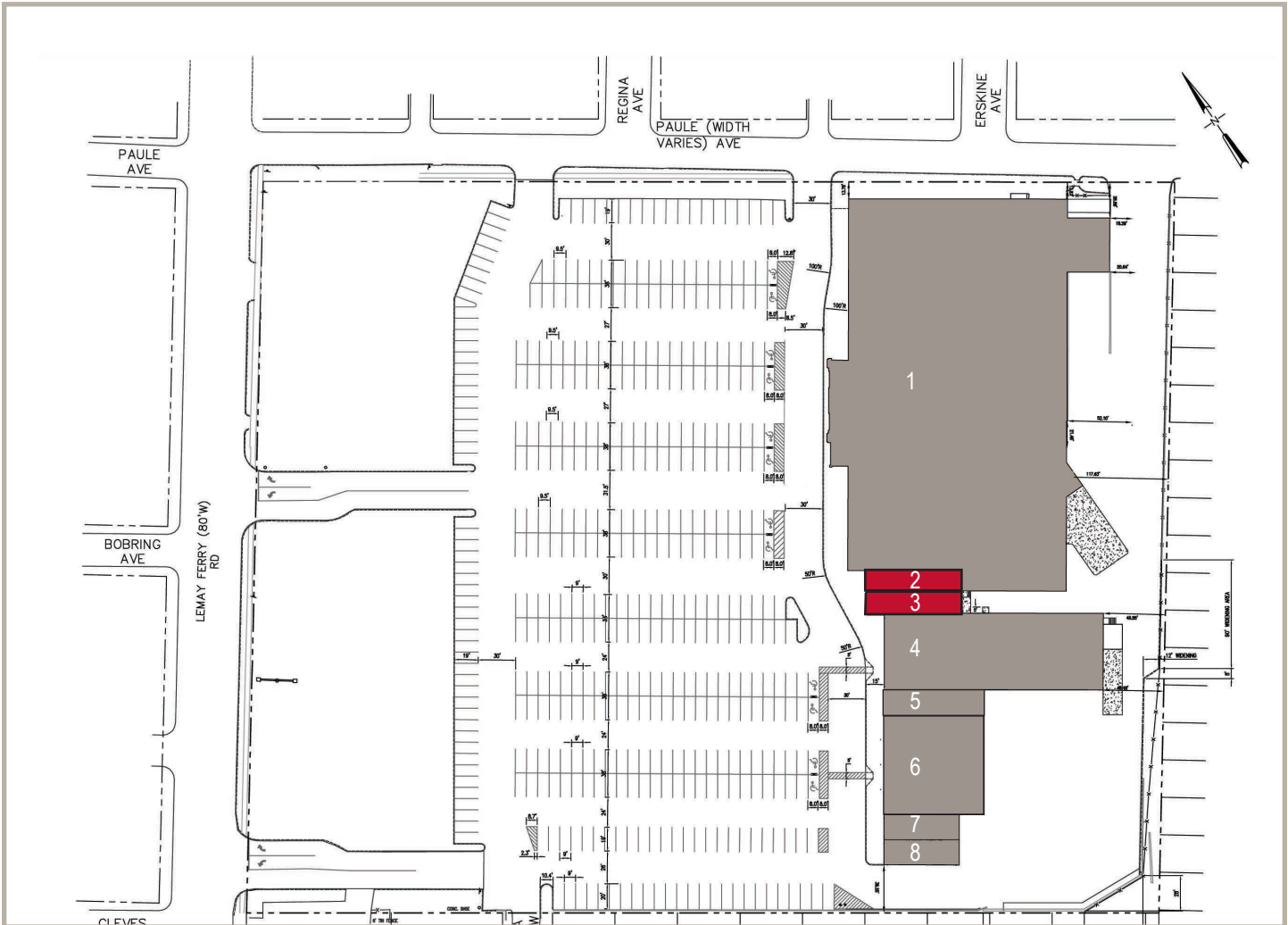

NUMBER	TENANT NAME	SF	NUMBER	TENANT NAME	SF
1	Schnucks	56,198	5	China King	1,600
2	<b>AVAILABLE</b>	<b>1,500</b>	6	Aaron's Rents	6,400
3	<b>AVAILABLE</b>	<b>1,000</b>	7	Jackson Hewitt	1,200
4	Dollar General	10,500	8	Cricket	1,200

**PROPERTY DETAILS**

- Excellent population density
- Anchored by renovated and expanded Schnucks
- New small shop space
- Strong area demand for quality retail

**TRAFFIC COUNTS**

Lemay Ferry Road: 9,000 VPD