

2024 DEMOGRAPHICS

1 Mile | 3 Miles | 5 Miles



Population

19,947 | 131,381 | 324,297



Daytime Population

16,316 | 147,499 | 318,227



Median Household Income

\$77,070 | \$78,319 | \$71,535



RETAIL FOR LEASE

6261 Delmar Boulevard | University City, Missouri 63130
5,218 SF | Call for Details | Triple Nets: \$6.50/SF (2024 actual)

PROPERTY DETAILS

Second-generation restaurant space
with over 50 feet of frontage to Delmar Boulevard

First floor of The Lofts, a mixed-use development providing
off-campus housing to 400+ Washington University students

Delmar Boulevard - 15,918 VPD

Kate Grewe

314.785.7662

kgrewe@paceproperties.com

Lauren Berry, CCIM

314.785.7632

lberry@paceproperties.com

PACEPROPERTIES.COM | 314.968.9898

1401 South Brentwood Boulevard, Suite 900 | St. Louis, Missouri 63144

The information contained herein is not warranted, although it has been obtained from the owner/landlord of the subject property or from other sources that Pace Properties, Inc. deems reliable, and is subject to change without notice. Owner/landlord and Pace Properties, Inc. make no representations as to the environmental condition of the subject property and recommend tenant's independent investigation.

Trade Area Aerial

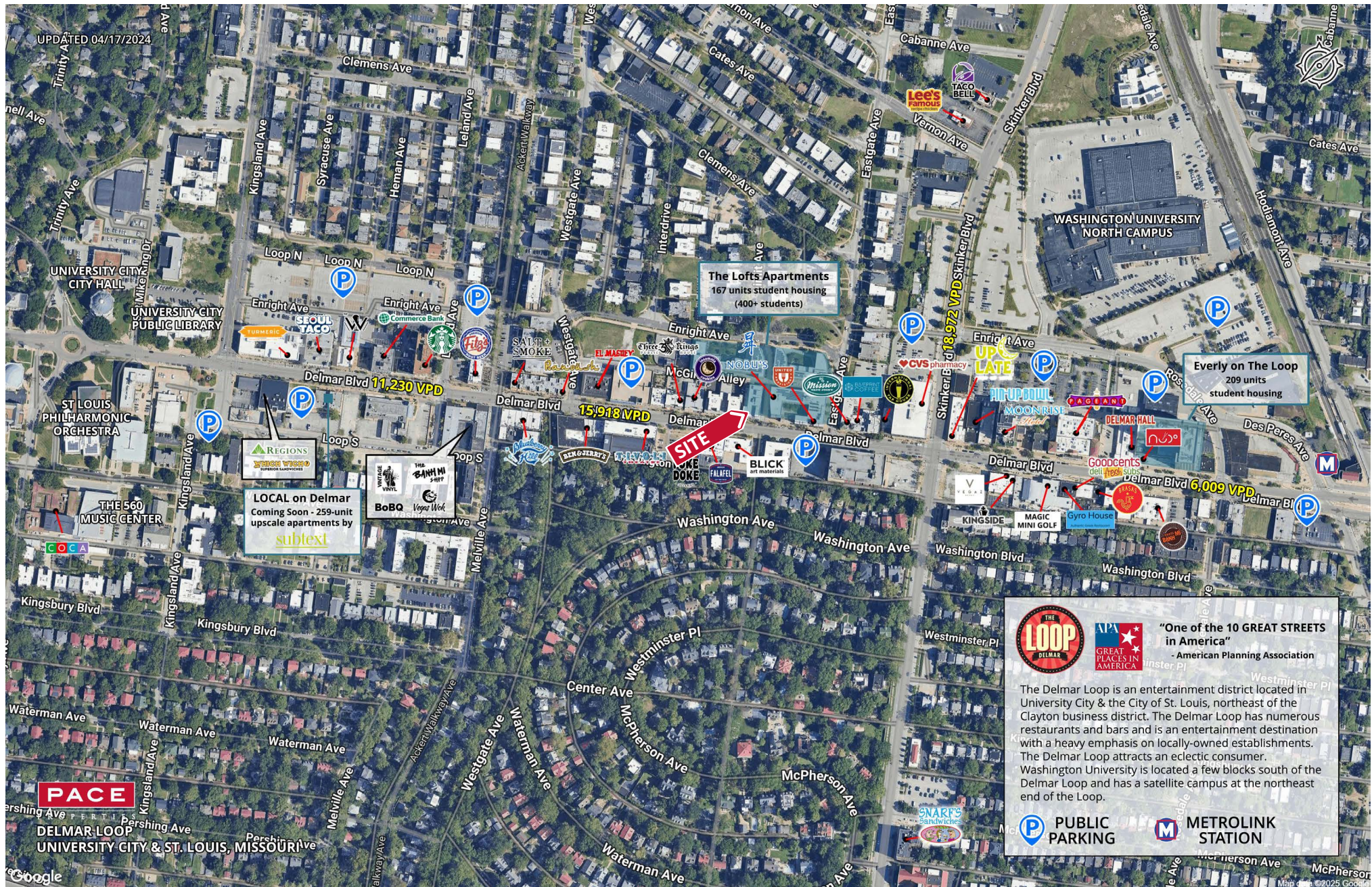

PACEPROPERTIES.COM | 314.968.9898

1401 South Brentwood Boulevard, Suite 900 | St. Louis, Missouri 63144

The information contained herein is not warranted, although it has been obtained from the owner/landlord of the subject property or from other sources that Pace Properties, Inc. deems reliable, and is subject to change without notice. Owner/landlord and Pace Properties, Inc. make no representations as to the environmental condition of the subject property and recommend tenant's independent investigation.

Floor Plan

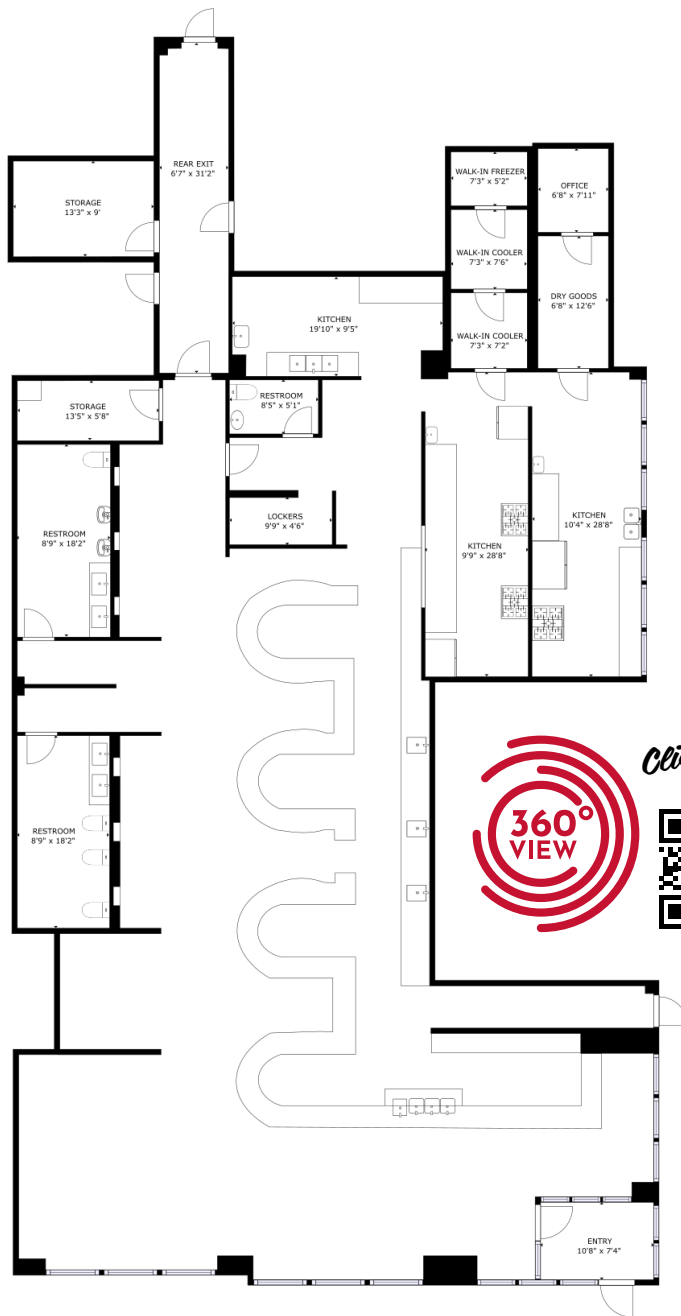

Click or Scan
to View!



PACEPROPERTIES.COM | 314.968.9898

1401 South Brentwood Boulevard, Suite 900 | St. Louis, Missouri 63144

The information contained herein is not warranted, although it has been obtained from the owner/landlord of the subject property or from other sources that Pace Properties, Inc. deems reliable, and is subject to change without notice. Owner/landlord and Pace Properties, Inc. make no representations as to the environmental condition of the subject property and recommend tenant's independent investigation.