

2025 DEMOGRAPHICS

1 Mile | 3 Miles | 5 Miles



Population

19,720 | 131,682 | 324,206



Daytime Population

13,450 | 141,802 | 313,515



Median Household Income

\$79,092 | \$83,709 | \$77,889

RETAIL FOR LEASE

6261 Delmar Boulevard | University City, Missouri 63130

5,218 SF | Call for Details | Triple Nets: \$11.99/SF (2026 estimate)

PROPERTY DETAILS

Second-generation restaurant space
with over 50 feet of frontage to Delmar Boulevard

First floor of The Lofts, a mixed-use development providing
off-campus housing to 400+ Washington University students

Delmar Boulevard - 16,189 VPD

Richie Chappuis

314.785.7615

rchappuis@paceproperties.com

Kate Grewe Milford

314.785.7662

kgrewe@paceproperties.com

Lauren Berry, CCIM

314.785.7632

lberry@paceproperties.com

PACEPROPERTIES.COM | 314.968.9898

1401 South Brentwood Boulevard, Suite 900 | St. Louis, Missouri 63144

The information contained herein is not warranted, although it has been obtained from the owner/landlord of the subject property or from other sources that Pace Properties, Inc. deems reliable, and is subject to change without notice. Owner/landlord and Pace Properties, Inc. make no representations as to the environmental condition of the subject property and recommend tenant's independent investigation.

Trade Area Aerial

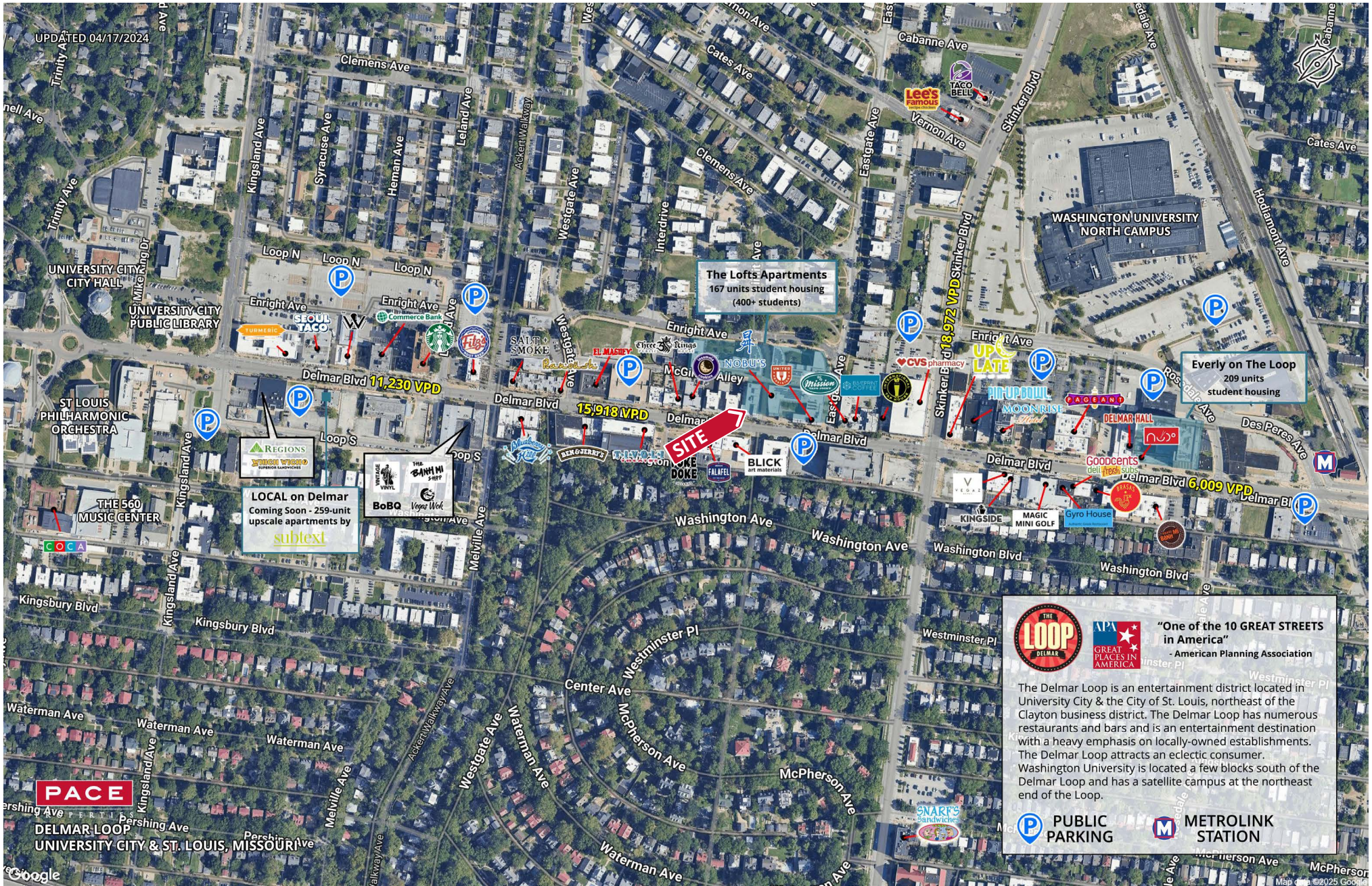

THE LOOP DELMAR

"One of the 10 GREAT STREETS in America"
- American Planning Association

The Delmar Loop is an entertainment district located in University City & the City of St. Louis, northeast of the Clayton business district. The Delmar Loop has numerous restaurants and bars and is an entertainment destination with a heavy emphasis on locally-owned establishments. The Delmar Loop attracts an eclectic consumer. Washington University is located a few blocks south of the Delmar Loop and has a satellite campus at the northeast end of the Loop.

P PUBLIC PARKING **M METROLINK STATION**

PACEPROPERTIES.COM | 314.968.9898

1401 South Brentwood Boulevard, Suite 900 | St. Louis, Missouri 63144

The information contained herein is not warranted, although it has been obtained from the owner/landlord of the subject property or from other sources that Pace Properties, Inc. deems reliable, and is subject to change without notice. Owner/landlord and Pace Properties, Inc. make no representations as to the environmental condition of the subject property and recommend tenant's independent investigation.

Floor Plan

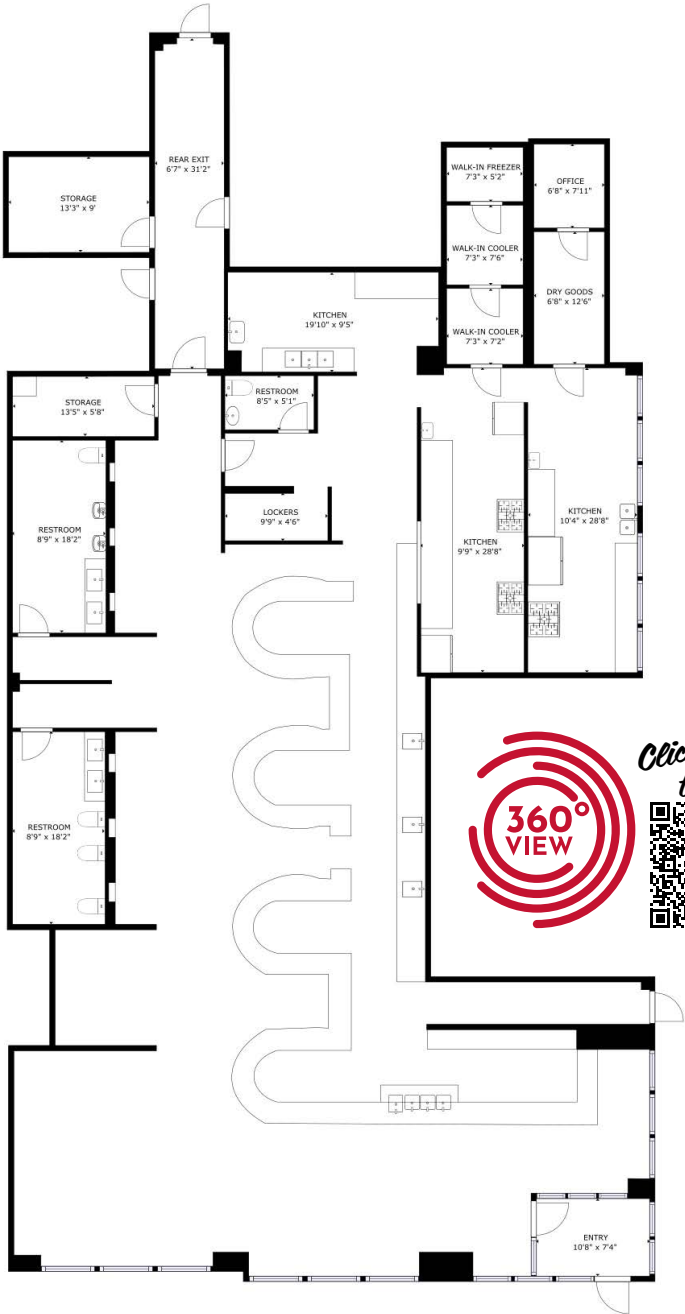

Click or Scan to View!

