

2025 DEMOGRAPHICS

1 Mile | 3 Miles | 5 Miles



Population

12,764 | 64,873 | 174,501



Daytime Population

9,246 | 44,974 | 102,331



Median Household Income

\$86,826 | \$98,707 | \$104,898



RETAIL FOR LEASE

7090 - 7098 Mexico Road | St. Peters, Missouri 63376

1,400 SF | Lease Rate: \$30.00/SF, NNN

PROPERTY DETAILS

Strong retail node

Ample parking and great visibility

Cross-access with CVS

Strong demographics

Mexico Road - 19,163 VPD | Mid Rivers Mall Drive - 25,345 VPD

Connor Wiemann

314.785.7627

cwiemann@paceproperties.com

[PACEPROPERTIES.COM](https://www.paceproperties.com) | 314.968.9898

1401 South Brentwood Boulevard, Suite 900 | St. Louis, Missouri 63144

The information contained herein is not warranted, although it has been obtained from the owner/landlord of the subject property or from other sources that Pace Properties, Inc. deems reliable, and is subject to change without notice. Owner/landlord and Pace Properties, Inc. make no representations as to the environmental condition of the subject property and recommend tenant's independent investigation.

Trade Area Aerial



Site Plan

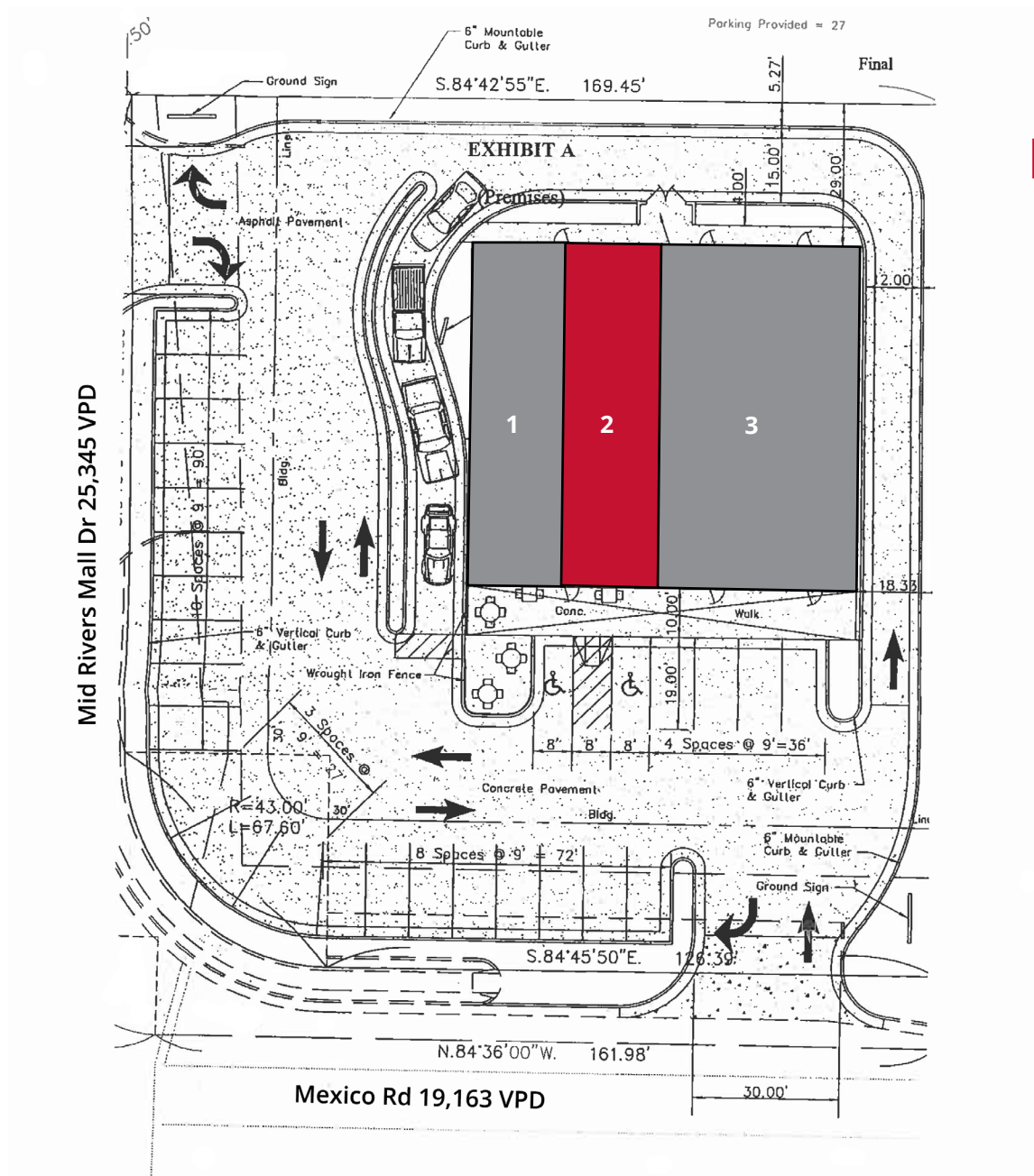

Space	Status	SF
1	Starbucks	1,400
2	AVAILABLE	1,400
3	Oberweis	2,800