



2024 DEMOGRAPHICS

1 Mile | 3 Miles | 5 Miles



Population

4,024 | 34,039 | 44,526



Daytime Population

11,866 | 37,150 | 43,056



Median Household Income

\$41,454 | \$55,768 | \$59,385



RETAIL FOR LEASE

West Park Plaza | 3047 William Street | Cape Girardeau, Missouri 63701
7,908 - 8,300 SF | Call for Details | Triple Nets: \$4.91/SF

PROPERTY DETAILS

Strip center located on outparcel of West Park Mall

Regional shopping hub for southeastern Missouri

Easy Interstate access

Excellent visibility from William Street

Ample parking

William Street - 23,988 VPD

Connor Wiemann

314.785.7627

cwiemann@paceproperties.com

Mike Sweargin

314.785.7635

msweargin@paceproperties.com

PACEPROPERTIES.COM | 314.968.9898

1401 South Brentwood Boulevard, Suite 900 | St. Louis, Missouri 63144

The information contained herein is not warranted, although it has been obtained from the owner/landlord of the subject property or from other sources that Pace Properties, Inc. deems reliable, and is subject to change without notice. Owner/landlord and Pace Properties, Inc. make no representations as to the environmental condition of the subject property and recommend tenant's independent investigation.

[illegible]

Site Plan

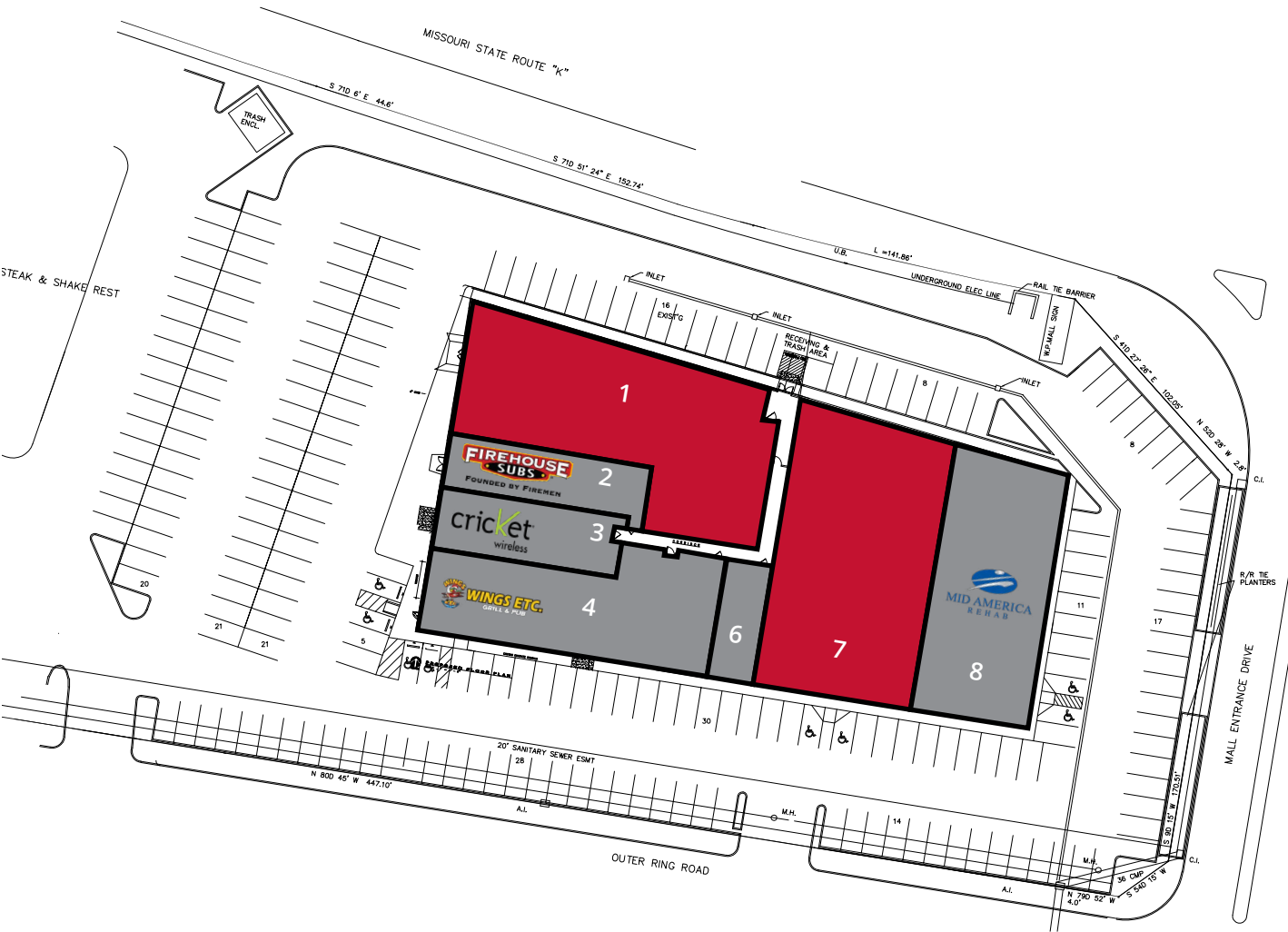

| Space | Status | SF |
|-------|-------------------|--------|
| 1 | AVAILABLE | 8,300 |
| 2 | Firehouse Subs | 2,095 |
| 3 | Cricket Wireless | 2,163 |
| 4 | Wings Etc. | 5,169 |
| 6 | Regional Finance | 1,101 |
| 7 | AVAILABLE | 7,908 |
| 8 | Mid America Rehab | 5,642 |
| TOTAL | | 32,378 |